

Rejecter Series

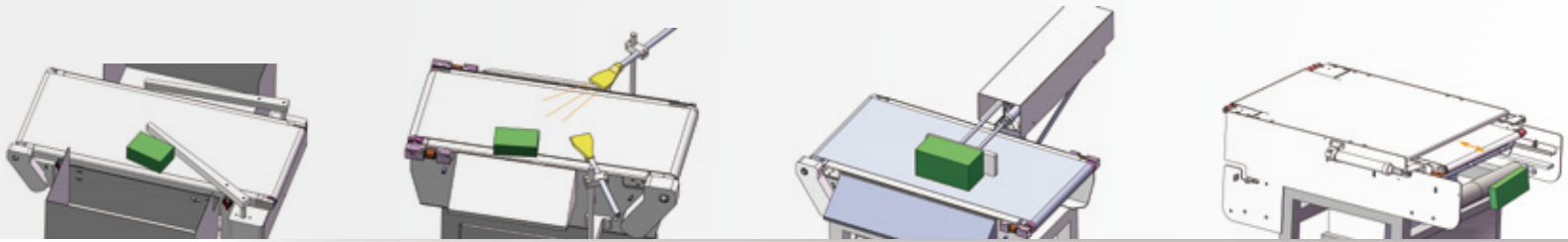

Flipper Type

To reject the products detected to different directions by 1~2 arm levers, which is suitable for the boxed, bag products.

Air Jet Type

To reject the products detected by using the blowing air, which is suitable for the high-speed sorting of the small and light weight products.

Push Type

To reject the products detected by pushing lever, which is suitable for small and large packing products.

Pneumatic Retracting Band Type

To reject the products by two active baffles, which is suitable for the small packed and non-packed products.

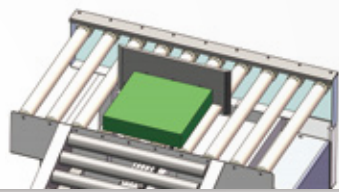

Heavy Push Rejecter

To reject products by pushing lever, especially suitable for the product with big size and heavy weight.

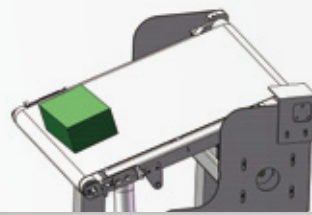

Drop Out Rejecter

To reject the products detected by partial belt flap, which is suitable for packed and non-packed products.

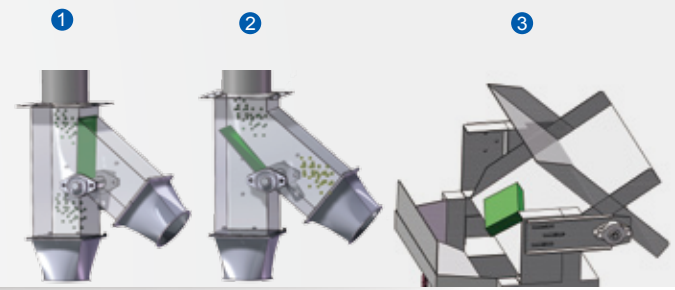

Flap Rejecter

To reject the products detected by the active flap, which is suitable for the dry products in bulk.